

Zoom Camera

ATC-UZ5707U-M



- 1/1" Progressive Scan Global Shutter CMOS
- 84x AF Zoom(7x optical zoom, 12x digital zoom)
- 4K UHD (3840 x 2160 / 30fps)
- Mechanical Day&Night
- True WDR
- 3D DNR, Defog
- UART RS232-TTL(Pleco-D, Pelco C, VISCA, Hitachi)
- P-IRIS
- 2x Mipi CSI-2 (4 Lanes)
- 2160p@30fps, 1080p@60/30fps, 720p@60/30fps

ATC-UZ5707U-M



· Dimensions

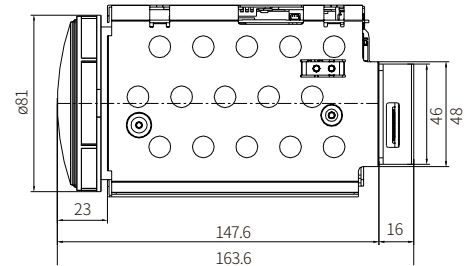
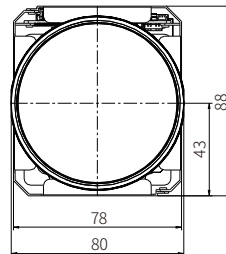

Specifications

Image Sensor	1/1" Progressive Scan Global Shutter CMOS	
Effective Pixels	8.95MP 4112(H) x 2176(V)	
Video Output mode	2x Mipi CSI-2 (4 Lanes) / CVBS	
Max. Video Resolution	2160p@30fps, 1080p@60/30fps, 720p@60/30fps	
Synchronization system	Internal	
Min.Illumination	Day mode: 0.1(Lux(F1.6)) Night mode: 0.06Lux(F1.6/ IR-cut filter on) Sens-Up off, AGC28dB	
S/N Rate	More than 52dB(AGC off, Sens-Up off)	
Lens	Type	AF Optical zoom lens(P-Iris)
	Focal Length	f=12mm~84mm
	F-value	F1.5(W)~2.6(T)
	Angle of View	Horizontal 61.19°(W)~9.66°(T), Vertical 34.75°(W)~5.12°(T)
Zoom ratio	Optical 7x / Digital 12x	
Focus Min.Working Distance	0.5m(Wide)/2.5m(Tele)~∞	
Focus Control	Auto/Manual/Interval/One Push/Preset	
AE mode	Auto/Shutter Priority/Iris Priority/Manual	
Brightness	0~14	
Manual Shutter	1/1, 1/2, 1/4(3), 1/8(6), 1/15(12), 1/30(25), 1/60(50)~1/10000	
Manual Iris	F1.5~F32, Close	
Sense-up	Off~32fields	
ETC	Spot AE, Slow AE	
D&N Mode	Auto/Day(Color)/Night(BW)/External-H or L	
White Balance	AUTO/ATW/Indoor/Outdoor/OnePush/Manual	
Image Freeze	Off/On	
Image Flip	Off/Horizontal/Vertical/H+V(180°Flip)	
Privacy Mask Zone	16 Zones/14 mask color selectable, semi-transparency	
Digital Image Stabilization	Yes	
Motion Detection	4 Zones	

D-WDR	Off/Low/Middle/High	
WDR	Off/Low/Middle/High	
BLC	Off/On, Area selectable	
HLC	Off/0~20, Color selectable	
AGC	Max.48dB	
Sharpness	Adjustable(0~15)	
3D-DNR	On/Off(1~5)	
2D-DNR	Auto/Manual	
Defog	Off/Low/Middle/High	
Preset Position	256 position Presets(Zoom,Focus), 16Memory Presets, Custom Preset	
Language	English	
UART	Remote	RS232 TTL +5.0V(+3.3V compatible)
	Protocol	VISCA/Pelco-D/Pelco-P/Hitachi: Automatic detection
	Baud rate	2400/4800/9600/19200/38400/57600/115200bps
UTC	-	
Supply Voltage	12VDC	
Power Consumption	Max. 11W / Non-working zoom& focus 9.0W	
Dimension(mm)	80x88x163.6mm	
Weight	Approx.920g	
Operating Temperature	-10°C~+50°C, Humidity(20~80%)	
Storage Temperature	-20°C~+60°C, Humidity(20~95%)	